





- Mid-Terraced House
- Two Bedrooms
- Gas Central Heating
- No Onward Chain
- Public Transport Links
- Great Location
- Family Bathroom
- Off-Street Parking
- Local Facilities
- Council Tax Band *B*





Jan Forster Estates welcome to the market this well-presented terraced home positioned on the popular Gardner Park Estate. The property is close to good local facilities and public transport links to the coast and Newcastle city centre, and will make a great home for the first time buyer or a great opportunity for the professional landlord.

The accommodation, which covers two floors and is offered with the benefit of no upper chain, briefly comprises;- main reception room, well-appointed kitchen with wall and floor units, fitted oven and hob, and a dining area. On the first floor, you are presented with two bedrooms and a modern bathroom WC. As you would expect, the house is warmed with gas central heating and also boasts double glazing. Externally, there is a garden to the rear and off-street parking to the front.

For more information or to book your viewing, please, call our coastal sales team on 0191 257 2000.

Tenure

The agent understands the property to be freehold. However, this should be confirmed with a licensed legal representative.

Council Tax band *B*



Ground Floor

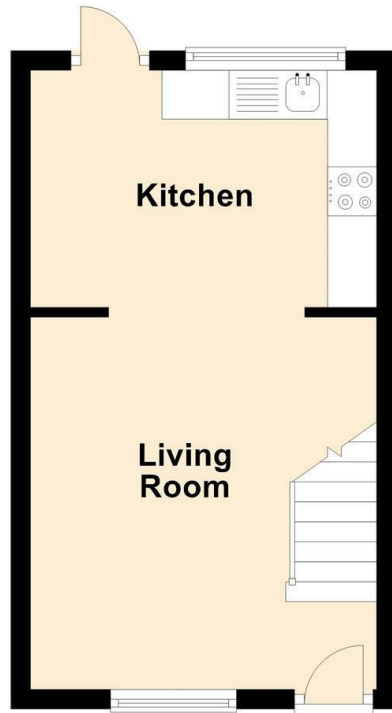

First Floor



Lounge 12'5" x 11'6" (3.80 x 3.53)

Kitchen 11'6" x 7'11" (3.53 x 2.42)

Bedroom One 12'5" x 11'6" (3.80 x 3.53)

Bedroom Two 7'11" x 5'5" (2.42 x 1.67)

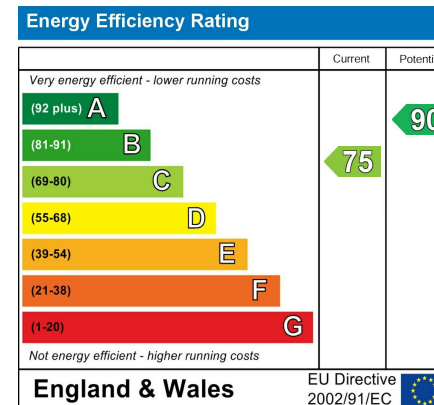

The difference between house and home

You may download, store and use the material for your own personal use and research. You may not republish, retransmit, redistribute or otherwise make the material available to any party or make the same available on any website, online service or bulletin board of your own or of any other party or make the same available in hard copy or in any other media without the website owner's express prior written consent. The website owner's copyright must remain on all reproductions of material taken from this website.



www.janforsterestates.com

Gosforth
High Heaton
Tynemouth
Property Management Centre

0191 236 2070
0191 270 1122
0191 257 2000
0191 236 2680

