





3



1



2

- End Of Terrace House
- Three Bedrooms
- Two Balconies
- Beautiful Views
- Transport Links
- Sought-After Area
- En-Suite Facility
- Garage + Driveway
- Local Facilities
- Council Tax Band *D*





**** Video Tour on our YouTube Channel |**
<https://youtu.be/rang4dJ5AFQ> ******

Jan Forster Estates welcome to the sale market this well-presented end of terrace house, positioned in a sought-after area, next to the The Marina, with some lovely park and Riverside walks nearby.

The accommodation briefly comprises to the ground floor;- entrance hallway, handy utility area with garage access, bedroom three and a downstairs WC. Off the landing to the first floor, you are presented with a spacious lounge with feature fireplace and sliding doors leading to the balcony, which enjoys beautiful views of the marina, and a well-appointed kitchen-diner with floor and wall units. To the second floor, there two bedrooms- the main one benefitting from an en-suite facility and a small balcony accessed via sliding doors, and there is also a three-piece family bathroom WC.

Externally to the front, there is a driveway leading up to the attached garage. To the rear, there is a small lawned garden with patio area, which enjoys the beautiful views of the marina.

The location of this property is within easy reach of the A19, Tyne Tunnel and A1058 Coast Road, so you have a direct route to the coast and Newcastle city centre. There are good transport links nearby along with a fantastic variety of amenities, including the Royal Quays Shopping outlet, bars, and restaurants.

To book a viewing or for more information, please, call our coastal branch on 0191 257 2000.

Tenure

The agent understands the property to be leasehold. However, this should be confirmed with a licenced legal representative.

Council Tax band *D*



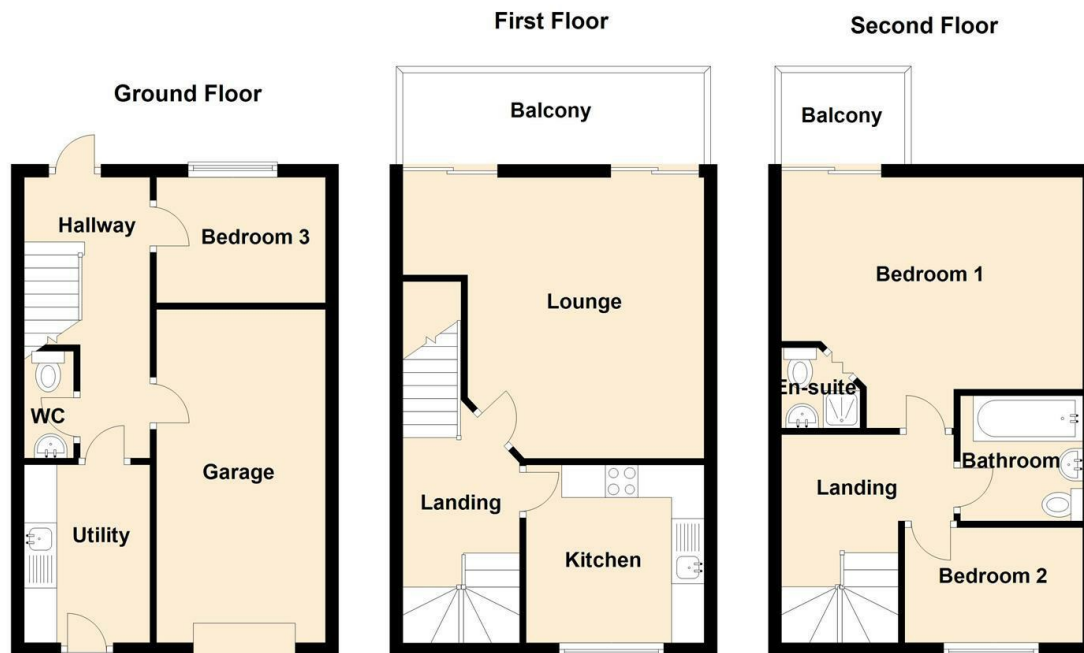

Lounge 15'1" x 14'1" (4.62 x 4.31)

Kitchen 8'11" x 8'11" (2.73 x 2.73)

Utility 8'11" x 6'3" (2.73 x 1.93)

Bedroom One 15'1" x 10'7" (4.62 x 3.25)

Bedroom Two 8'11" x 5'9" (2.73 x 1.77)

Bedroom Three 8'5" x 6'3" (2.59 x 1.93)

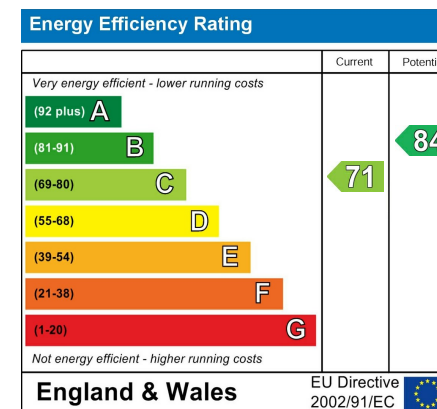

The difference between house and home

You may download, store and use the material for your own personal use and research. You may not republish, retransmit, redistribute or otherwise make the material available to any party or make the same available on any website, online service or bulletin board of your own or of any other party or make the same available in hard copy or in any other media without the website owner's express prior written consent. The website owner's copyright must remain on all reproductions of material taken from this website.



www.janforsterestates.com

Gosforth

0191 236 2070

Newcastle

0191 284 4050

High Heaton

0191 270 1122

Tynemouth

0191 257 2000

Low Fell

0191 487 0800

Property Management Centre

0191 236 2680

